

LED INDICATOR SOLID FRONT WATERTIGHT PANEL SEAL



Model ML2030

Designed for use where a watertight panel seal is required for system performance. Can be used as a function indicator on aircraft avionics systems, test equipment, medical equipment, machine tools, and wherever severe environmental conditions are present.

FEATURES

- O-ring panel seal
- Dual finish case
- Low power use
- Performs in severe environments
- Rugged construction

MECHANICAL SPECIFICATIONS

Case: Aluminum, black anodized front bezel with conductive clear chromate body.

Mounting: Front panel mount with 5/16"-32 nut and lock washer.

Seal: Environmentally sealed case. MIL-DTL-3661, Para. 4.6.11.1

O-ring: Fluorosilicone rubber

ML2030E

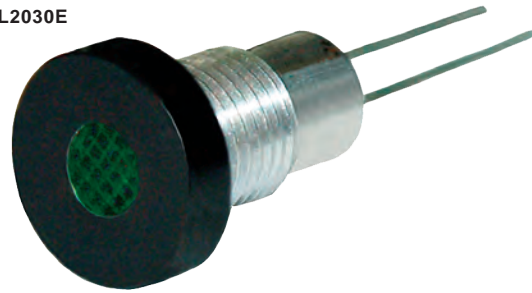

ENVIRONMENTAL SPECIFICATIONS

Vibration: .06" D.A. or 20 Gs Peak, whichever is less, 10Hz to 2kHz, MIL STD 202, Method 204, Test Condition D

Shock: 100 Gs MIL STD 202, Method 213, Test Condition I

Moisture Resistance (Humidity): MIL STD 202, Method 106

Barometric Pressure (Reduced): 100,000 ft., MIL STD 202, Method 105, Test Condition D

Reliability: 3 x 10⁶ hours min. MTBF @ 25°C

Salt Atmosphere (Corrosion): MIL STD 202, Method 101, Test Condition B

ELECTRO-OPTICAL CHARACTERISTIC SPECIFICATIONS

Absolute Maximum Ratings @Temp = 25°C			
Color	Red	Yellow	Green
Forward Voltage (VDC)	1.9	2.0	2.1
DC Forward Current (mA DC) ①	30	20	30
Reverse Voltage (VDC) @ I _R = 100 µA	5	5	5
Power Dissipation (mW)	135	85	135
Luminous Intensity (mcd) typical @ I _F = 10 mA	Non-diffused	60	50
	Diffused	11	12
Dominant Wave Length (nm) typical	626	585	569
Viewing Angle (2 Ø ^{1/2}) typical	Non-diffused	35°	24°
	Diffused	60°	60°
Operating Temperature (°C)	-55 to +100	-55 to +100	-20 to +100
Storage Temperature (°C)	-55 to +100	-55 to +100	-55 to +100
Lead Soldering Temperature	260°C for 5 seconds		

Notes: ① For red and green, derate linearly from 50°C @ 0.5 mA/°C. For yellow derate linearly from 50°C @ 0.2 mA/°C

This page consists of basic marketing information that is not defined as technical data under EAR Part 772.

LED INDICATOR SOLID FRONT WATERTIGHT PANEL SEAL



ORDERING INFORMATION

When ordering, show basic part number first, LED color, lens type, and terminal style. If this part requires customization, a special factory assigned modification number will be assigned to the end of the ordering number. Consult the factory for special configurations.

Example: Basic model with EMI screen, a red LED, a diffused lens, and looped terminals would be ML2030E-R-D-LT.

ML2030E - R - D - LT - ()

Standard factory options are designated by "-Sxxx"

Basic Model Number	EMI Screen	LED Color	Lens Type	Terminal Style
ML2030		R Red	ND Non-diffused	ST Straight Leads
	E Screen	Y Yellow	D Diffused	LT Loop Terminals
		G Green		

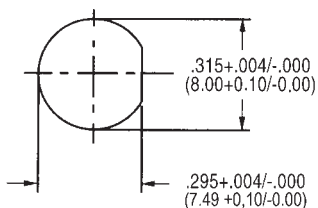
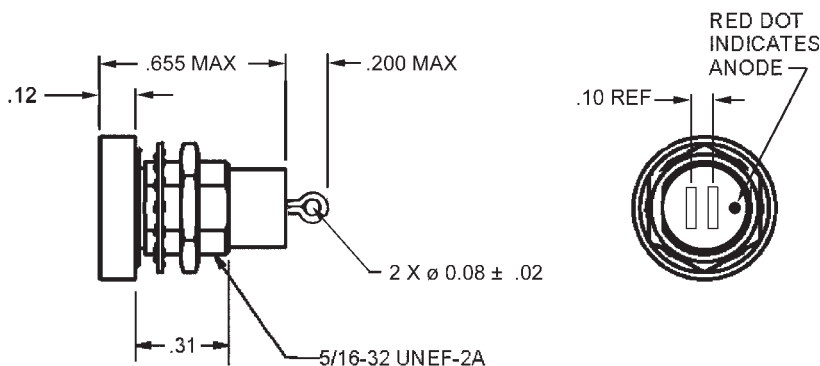
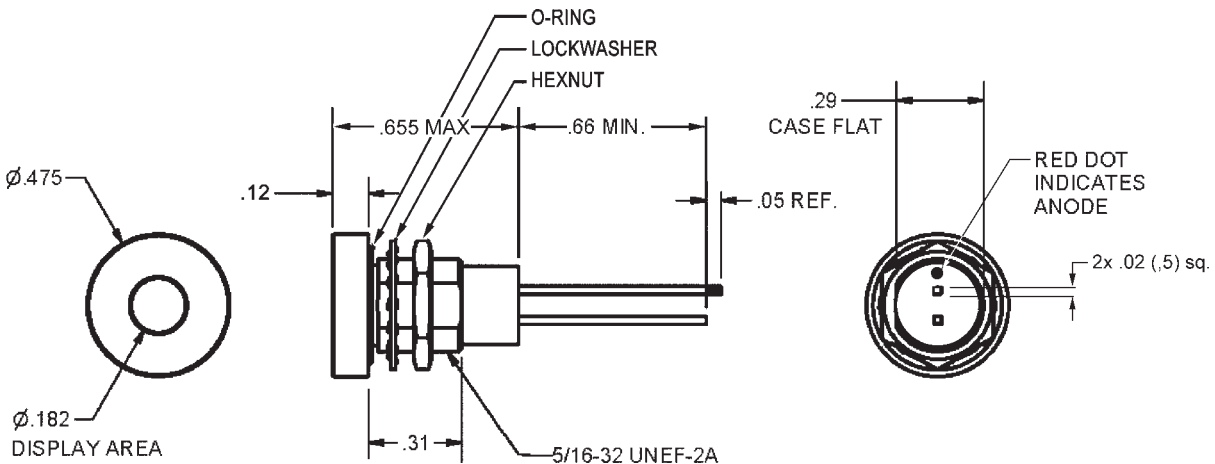

**Recommended
Mounting Hole**

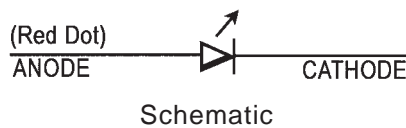

NOTE:
Ø .475 AND FRONT SURFACE OF FLANGE IS BLACK ANODIZED.
ALL OTHER SURFACES ARE CLEAR CHROMATE.

ML2030

NOTE: Dimensions in () are mm. Tolerances: Decimals: ± .010 (0.25)
Fractions: ± 1/64 Mounting Torque: 10-12 in. lbs.

This page consists of basic marketing information that is not defined as technical data under EAR Part 772.

LED INDICATORS