

# LED INDICATOR MIL-SPEC

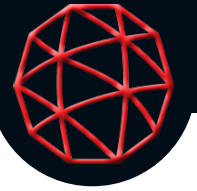

## ML1640C Commercial Series

ML1640C



Developed for use as a function indicator, this solid-state lamp with plain or filtered type lens, designed for sunlight viewing.

It is panel mountable with solderable leads and includes hardware. Available with anti-reflection lens coating.

### FEATURES

- Environmentally sealed
- Panel mount
- Optional EMI protection screen
- Colors: red, yellow & green

### MECHANICAL SPECIFICATIONS

Bezel: Aluminum, black anodized

Case: Aluminum, clear chromate

Mounting: Front panel by 5/16"-32 nut and lockwasher

Seal: Environmentally sealed with front panel PTFE ring seal

### ELECTRO-OPTICAL CHARACTERISTIC SPECIFICATIONS

Absolute Maximum Ratings @Temp = 25°C			
Color	Red	Yellow	Green
Forward Voltage (VDC) Typical $I_F$ @ 20 mA	1.9	2.1	2.2
Peak Forward Current (mA)	90	60	90
DC Forward Current (mA)	30	20	30
Reverse Voltage (VDC) @ $I_R = 100 \mu A$	5	5	5
Power Dissipation (mW)	135 Å	85 Å	135 Å
Luminous Intensity (mcd) typical	See chart	See chart	See chart
Dominant Wave Length (nm) typical	626	585	571
Operating Temperature (°C)	-55 to +100	-55 to +100	-20 to +100
Storage Temperature (°C)	-55 to +100	-55 to +100	-55 to +100
Lead Soldering Temperature	260°C for 5 seconds		

Notes: Å Derate at 1.8 mW/°C above +25°C Ambient  
 Å Derate at 1.6 mW/°C above +50°C Ambient

Model	Type of Lens	Anti Reflect Coating	EMI Screen	Outline Figure
ML1641C	Plano Convex	No	Optional	1
ML1644C	Plano Convex	No	Optional	2
ML1642C	Flat 30° View, Angle	Optional	Optional	3
ML1645C	Flat 30° View, Angle	Optional	Optional	4

Model	Color	
ML1641C ML1644C	Red	15 mcd @ 10 mA
	Yellow	12 mcd @ 10 mA
	Green	12 mcd @ 20 mA
ML1642C ML1645C	Red	10 mcd @ 20 mA
	Yellow	5 mcd @ 15 mA
	Green	10 mcd @ 20 mA

Luminous characteristics and/or exact operational parameters will vary depending on the model configuration. Please contact the L3Harris ElectroDynamics, Inc. Sales Department for model specification sheets.

This page cleared by DoD/OSR for public release under 12-5-1675 on 04/23/2012.

# LED INDICATOR MIL-SPEC

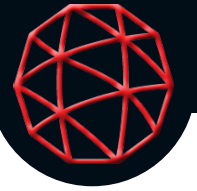

## ORDERING INFORMATION

When ordering, show model number first, then, EMI screen, coated lens, LED color and the type of lead desired. If this is a special part, a factory assigned modification number will be added at the end of the ordering number. Consult the factory for special configurations.

Example: Basic model with red LED, EMI screen, uncoated lens, and straight lead would be model ML1642CE-U-R-ST.

ML1642CE-U-R-ST				
Basic Model Number	EMI Screen	Lens Coating	LED Color	Terminal Style
ML1640C	( ) None	U Uncoated	R Red	ST Straight Leads
	E Screen	C Anti-reflection Coating	Y Yellow	LT Loop Terminals
			G Green	

\* ML1641C and ML1644C do not have the Antireflection Coating option.

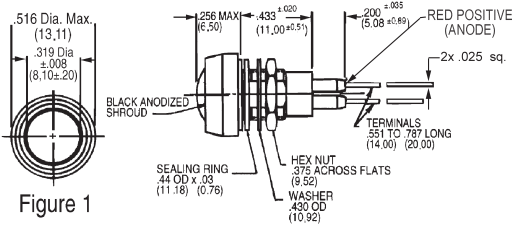

Figure 1

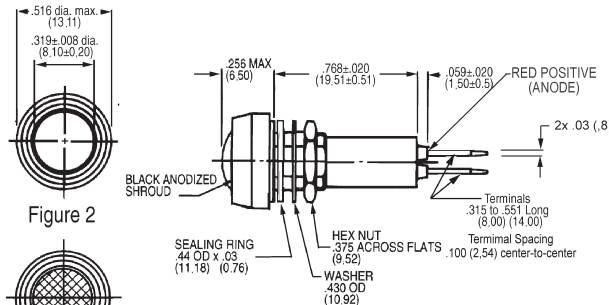
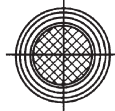

Figure 2



WITH EMI SCREEN

Figure 2a

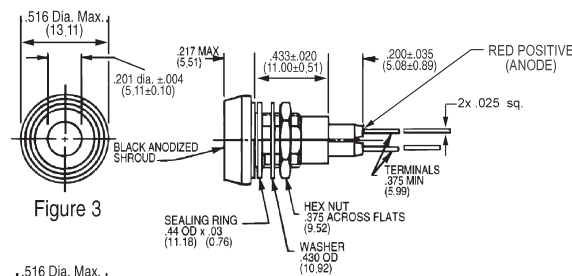

Figure 3

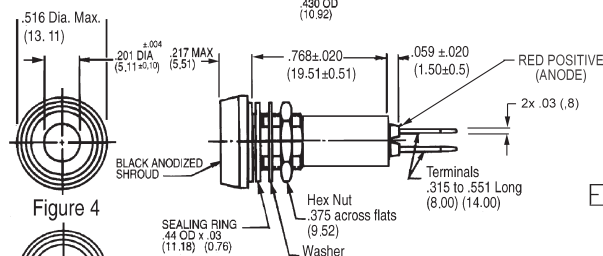
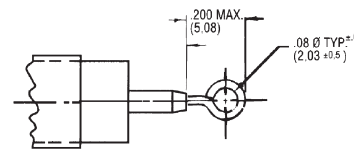

Figure 4



WITH EMI SCREEN  
Figure 4a



(-2) OPTIONAL LOOP TERMINAL

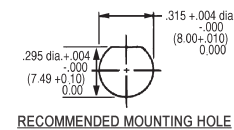

RECOMMENDED MOUNTING HOLE

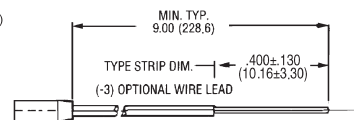

(-3) OPTIONAL WIRE LEAD

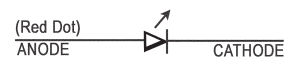

Schematic

### ML1640C Series

NOTE: Dimensions in ( ) are mm. Tolerances: Decimals: ± .010 (0.25)  
Fractions: ± 1/64 Mounting Torque: 5-7 in. lbs.

This page is the property of L3Harris Electrodynamic, Inc. and is not to be reproduced or transmitted in any form or by any means, electronic, mechanical, photocopying, recording, or by any information storage and retrieval system, without the prior written permission of L3Harris Electrodynamic, Inc.